

Kam Tai

Professional
High-Quality
Threaded Rods

KT 02



About Us

Headquartered in Hong Kong, Kam Tai Products operates in China, Hong Kong and Macau, providing customers with innovative solutions and services on large-scale construction projects.

We are firmly committed to becoming the preferred metal cable containment and cabling system supplier.

關於我們

金泰製品總部設於香港，業務遍佈中國，香港及澳門，曾完成多項大型及優質的建築項目，並為客戶提供創新的方案及服務。我們致力成為客戶首選的金屬電纜保護系統及佈線系統供應商。

What We Do

Kam Tai Products is dedicated to providing quality service and products. We aim to provide customers with a one-stop service using our series of products such as cable trunking, cable trays, cable ladders, cable baskets and U-channel supporting systems. We also supply all the necessary accessories and hardware to support cable containment installation such as threaded rod and screws. With more than 30 years of experience and skilled resources, we are able to deliver quality products that meets all customer needs.

專 業

金泰製品致力提供優質的服務及優良的產品，我們為客戶提供一站式服務及一系列的電線槽、電纜托盤、承托骨架等產品，及提供安裝所需的螺絲杆及螺絲配件等配套用小五金，憑藉超過三十年的經驗及資源，我們於每個工程項目均能準時為客戶交付優質而符合不同標準的產品。

Our History

We first set up our initial factory in China during the late 90's and due to an increased production demand, moved to our expanded Huizhou factory at Guangdong, which has a production area of more than 20,000 square meters. With the advanced automation and bespoke machinery developed by our in-house research and development team combined with our efficient and highly skilled labour force, we have successfully reduced the cost of production and increased our production capability by more than 20 times since the opening of our first plant.

We are also continuing to invest, and strive to move toward with advanced automated robotic machines, we believe that our combined experience, automation plant and highly trained workforce can continue to provide reliable and high quality, effective and competitive products to our customers.

匯集優勢

我們早於上世紀九十年代在國內廣東省自設廠房，經過多年的發展及擴充，現於廣東省惠州市自設合共超過20,000平方米的生產基地，憑藉先進的自動化及自家研發設備，我們成功將勞動成本由高峰期的超過400人減少至現今的不足於80人，而產能提升至由最初設廠時的20倍。我們亦不斷繼續投資，透過軟件優化及購置更先進的自動化生產機器設備，提高生產量及速度以發揮更大的成本效益。我們相信，憑藉我們豐富的經驗及資源，我們能夠為客戶提供優質、快捷及具競爭力的產品。



Threaded Rod



Channel Nut



Accessories



Threaded Rod

Grade 4.8/8.8

HDG/ZP Steel Threaded Rods 3000mm

熱浸鉛水/鍍鋅絲杆 3米

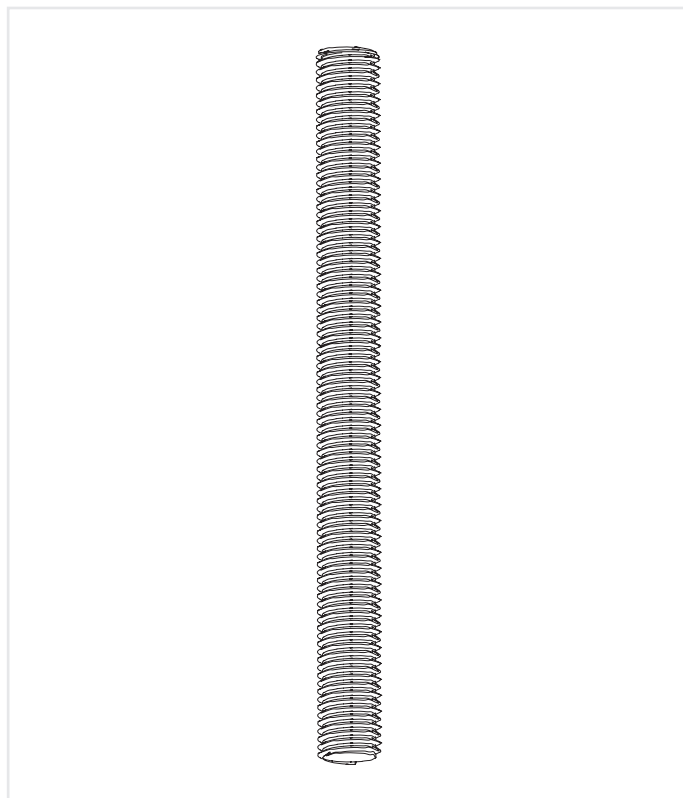

Material Standard

Grade 4.8 & Grade 8.8
to
ISO 898 Part 1: 2009

Material

Steel

Finishing

Hot dip galvanized to ISO 1461:1999
Zinc plated to BS 7371 - 12 : 2008

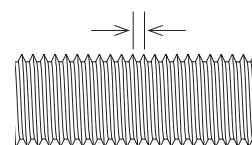

Thread Pitch

4.8 / 8.8 HDG / ZP Meter

Order example : HDG-8.8 M20x3000 (Order Code: 02033.200.300)

Size	Thread Pitch	02013	02001	02033	02031	Packing
		Grade 4.8 HDG 熱浸鉛水 4.8	Grade 4.8 ZP 鍍鋅 4.8	Grade 8.8 HDG 熱浸鉛水 8.8	Grade 8.8 ZP 鍍鋅 8.8	
M6	1.0	02013.060.300	02001.060.300		02031.060.300	50
M8	1.25	02013.080.300	02001.080.300		02031.080.300	25
M10	1.5	02013.100.300	02001.100.300	02033.100.300	02031.100.300	20
M12	1.75	02013.120.300	02001.120.300	02033.120.300	02031.120.300	10
M16	2.0	02013.160.300	02001.160.300	02033.160.300	02031.160.300	5
M20	2.5	02013.200.300	02001.200.300	02033.200.300	02031.200.300	5
M24	3.0	02013.240.300	02001.240.300	02033.240.300	02031.240.300	4
M27	3.0			02033.270.300	02031.270.300	2
M30	3.5			02033.300.300	02031.300.300	2
M33	3.5			02033.330.300	02031.330.300	1
M36	4.0			02033.360.300	02031.360.300	1
M39	4.0			02033.390.300		1
M42	4.5			02033.420.300		1
M45	4.5			02033.450.300		1
M48	5.0			02033.480.300		1
M52	5.0			02033.520.300		1



Threaded Rod

Inch Size Steel Threaded Rods 3000mm
英制絲杆 3米

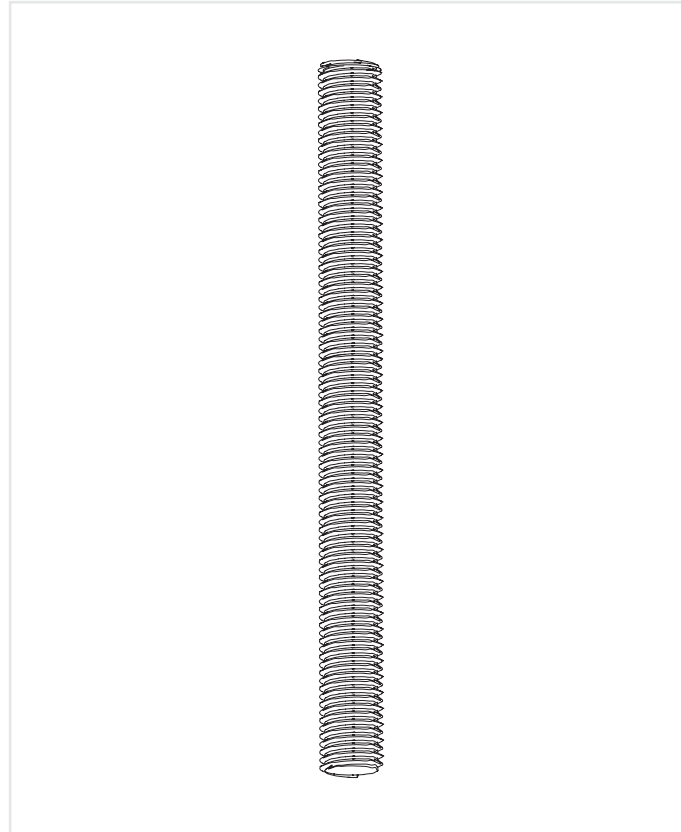

Material Standard

Grade 4.8 & Grade 8.8
to
ISO 898 Part 1: 2009

Material

Steel / Stainless Steel

Finishing

Hot dip galvanized to ISO 1461:1999
Zinc plated to BS 7371 - 12 : 2008

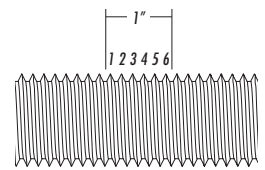

Threads per inch

02001 (DIN 975 ZP) / 72002 (ST/ A2)

Order example : DIN 975 ZP Steel 1/4x3000 (Order Code : 02001.063.300)

Size	Threads per inch	Grade 4.8 ZP 鍍鋅 4.8	Stainless Steel 白鋼	Packing
1/4	20	02001.063.300	72002.063.300	50
5/16	18	02001.079.300	72002.079.300	25
3/8	16	02001.096.300	72002.096.300	20
1/2	12	02001.127.300	72002.127.300	10
5/8	11	02001.158.300	72002.158.300	5
3/4	10	02001.191.300	72002.191.300	5
1	8	02001.254.300	72002.254.300	4
1-1/4	7	02001.317.300		2
1-1/2	6	02001.381.300		1



Threaded Rod

Grade SS304 / SS316 Threaded Rods 3000mm
不鏽鋼 SS304 / SS316 絲杆 3米

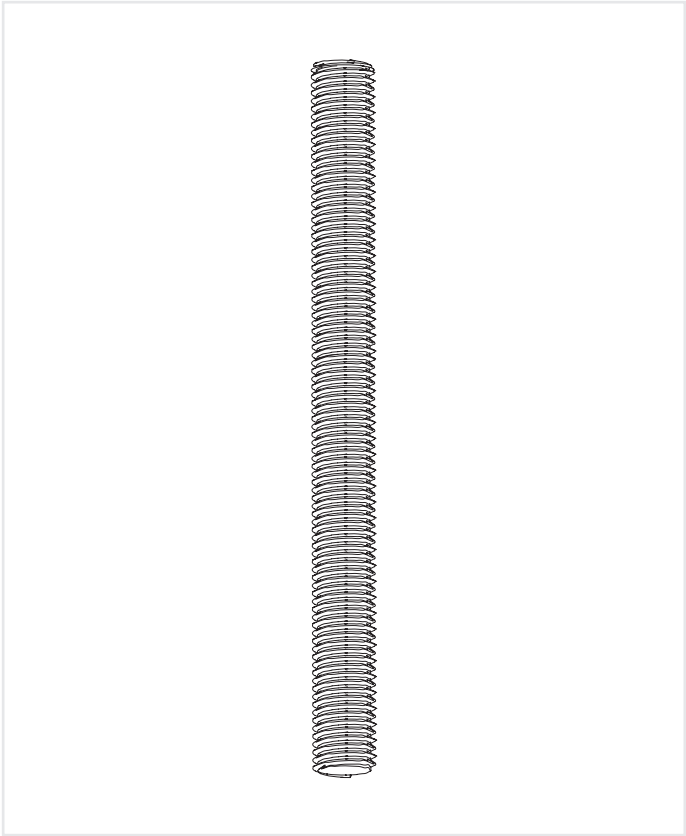

Material Standard

Grade SS304 & SS316

Material

Stainless Steel

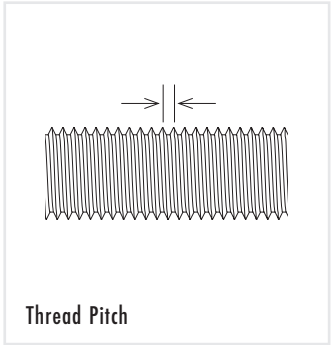

SS304 / SS316 Stainless Steel Meter
Order example : SS316 M20x3000 (Order Code : 00316.200.300)

		00304	00316	
Size	Thread Pitch	Grade SS304 不鏽鋼 SS304	Grade SS316 不鏽鋼 SS316	Packing
M6	1.0	00304.060.300	00316.060.300	50
M8	1.25	00304.080.300	00316.080.300	25
M10	1.5	00304.100.300	00316.100.300	20
M12	1.75	00304.120.300	00316.120.300	10
M16	2.0	00304.160.300	00316.160.200	5
M20	2.5	00304.200.300	00316.200.300	5
M24	3.0	00304.240.300	00316.240.300	4
M27	3.0			2
M30	3.5			2
M33	3.5			1
M36	4.0			1
M39	4.0			1
M42	4.5			1
M45	4.5			1
M48	5.0			1
M52	5.0			1

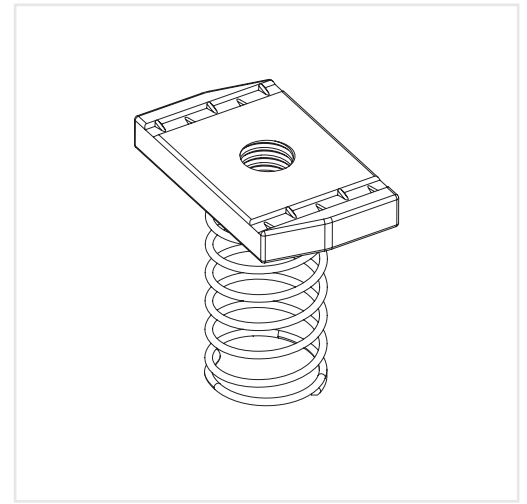
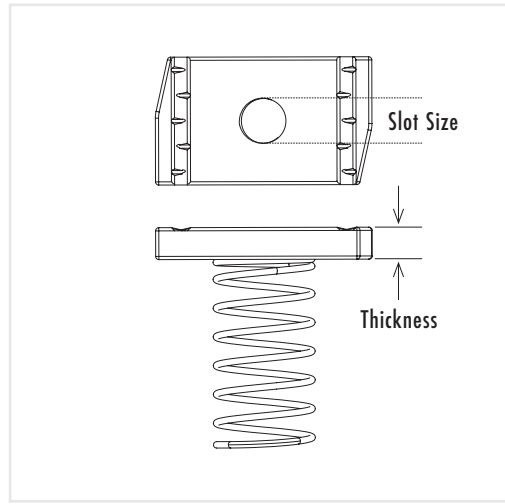

Long Spring Nut
for 41 x 41mm U-Channel

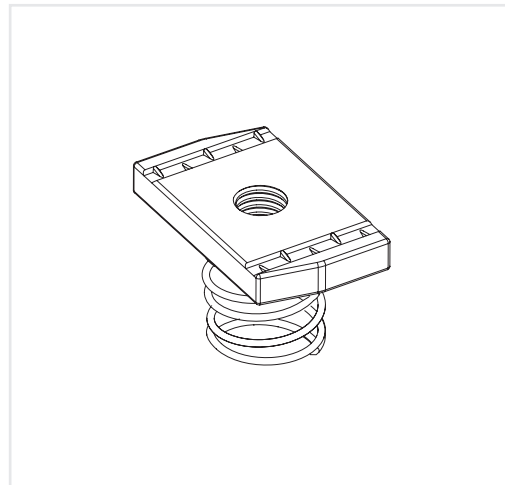

Short Spring Nut
for 21 x 41mm U-Channel

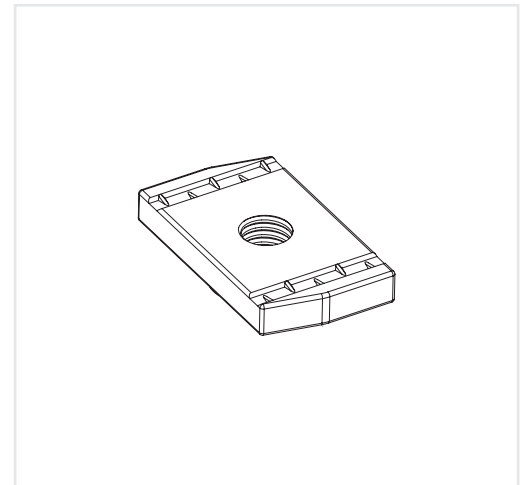

Channel nut
for 21 x 41mm U-Channel

Slot Size	Standard Product Code			
	Thickness	Long Spring	Short Spring	Channel Nut
M6	5mm	LSC - 6	SSC - 6	CN - 6
M8	6mm	LSC - 8	SSC - 8	CN - 8
M10	8mm	LSC - 10	SSC - 10	CN - 10
M12	8mm	LSC - 12	SSC - 12	CN - 12
M16	12mm	LSC - 16	SSC - 16	CN - 16



Accessories

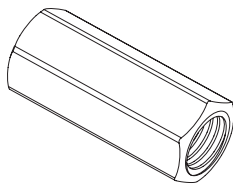

Product Code	Size
CPNM6	M6
CPNM8	M8
CPNM10	M10
CPNM12	M12

Threaded Rod Coupling
Product Code
CPN + Size

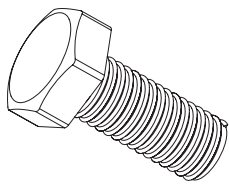

Product Code	Size
HSSM6	M6
HSSM8	M8
HSSM10	M10
HSSM12	M12

Hex Set Screw
Product Code
HSS + Size

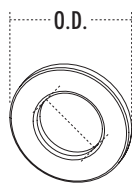

Product Code	Size	O.D.	
		for ZP/ HDG	for SS
FWM6	M6	19	12
FWM8	M8	22	15
FWM10	M10	25	20
FWM12	M12	32	23

Flat Washer
Product Code
FW + Size

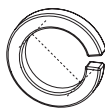

Product Code	Size
SWM6	M6
SWM8	M8
SWM10	M10
SWM12	M12

Spring Washer
Product Code
SW + Size

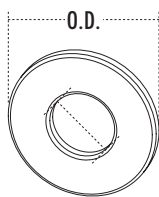

Product Code	Size	O.D.	
		for ZP/ HDG	for SS
SFWM6	M6	30	18
SFWM8	M8	30	24
SFWM10	M10	30	30

Fender Washer
Product Code
SFW + Size

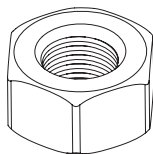

Product Code	Size
HN6	M6
HN8	M8
HN10	M10
HN12	M12

Hex Nut
Product Code
HN + Size

Material Standard

Standard Size:
M5 / M6 / M8 / M10
M12 / M16 / M20
Grade 4.8 & Grade 8.8
to
ISO 898 Part 1: 2009

Material

Steel / SS

Finishing

Hot dip galvanized to ISO 1461:1999
Zinc plated to BS 7371 - 12 : 2008



Accessories

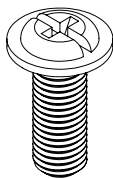

Product Code	Size
KFSM5	M5
KFSM6	M6
KFSM8	M8
KFSM10	M10

Flange Screw

Product Code
KFS + Size

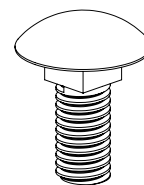

Product Code	Size
CSM6	M6
CSM8	M8
CSM10	M10
CSM12	M12

Cup Square Blot

Product Code
CS + Size

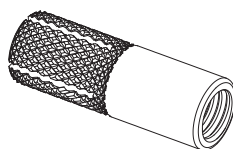

Product Code	Size
GBNM8	M8
GBNM10	M10
GBNM12	M12

Drop in Anchor

Product Code
DA + Size

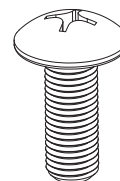

Product Code	Size
DHM5	M5
DHM6	M6
DHM8	M8
DHM10	M10

Dome Head Bolt

Product Code
DH + Size

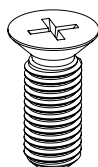

Product Code	Size
CHM5	M5
CHM6	M6
CHM8	M8
CHM10	M10

Counter Sunk Head Screw

Product Code
CH + Size

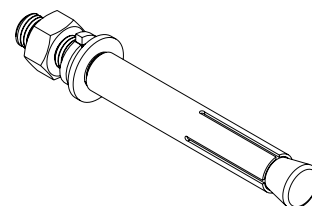

Product Code	Size
WAM8	M8
WAM10	M10
WAM12	M12

Wedge Anchor

Product Code
WA + Size

Material Standard

Standard Size:

M5 / M6 / M8 / M10

M12 / M16 / M20

Grade 4.8 & Grade 8.8

to

ISO 898 Part 1: 2009

Material

Steel / SS

Finishing

Hot dip galvanized to ISO 1461:1999

Zinc plated to BS 7371 - 12 : 2008



Address G/F, Lung Shing Factory Bldg.,
148 Texaco Road
Tsuen Wan, N.T.,
Hong Kong

Phone (852) 2407 8222

Fax (852) 2407 3000

Email cs@ktphk.com

WebSite www.ktphk.com

